

- 1 +28v DC INPUT
  - 2 +28v DC INPUT
  - 3 CANCEL/TEST INPUT
  - 4 +14 - 28v INPUT
  - 5 +3 - 5v INPUT
  - 6 - INPUT
  - 7 +14 - 28v INPUT
  - 8 +3 - 5v INPUT
  - 9 INPUT
  - 10 B (-) ARINC 429 INPUT
  - 11 A (+) ARINC 429 INPUT
  - 12 B1
  - 13 B2
  - 14 B4
  - 15 C1
  - 16 C2
  - 17 C4
  - 18 D4
  - 19 GND (CODE COMMON)
  - 20 GND (POWER)
  - 21 GND (POWER)
  - 22 NC
  - 23 W.D.W. GND IN
  - 24 (+) GEAR DOWN INPUT
  - 25 NC
  - 26 + SPARE FLAG INPUT
  - 27 - SPARE FLAG INPUT
  - 28 + SDA RS-422 TX
  - 29 - SDB RS-422 TX
  - 30 RS-232 RX
  - 31 RS-232 TX
  - 32 A1
  - 33 A2
  - 34 A4
  - 35 WARN 1 OUTPUT (+28V)
  - 36 WARN 2 OUTPUT (GND)
  - 37 WARN 3 OUTPUT (GND)
- } OPTIONAL
- } GRAY CODE ALTITUDE OUTPUT
- } OPTIONAL
- } GRAY CODE ALTITUDE OUTPUT
- } OPTIONAL

9906/012	-	6-18-99	PAB	EDJ	BASELINE RELEASE
ECD #	REV.	DATE	BY	APP'D	DESCRIPTION

SCALE NONE

DRAWING DATE 6/18/99		SHADIN CO., INC. MINNEAPOLIS, MN 55426		
DRAFTSMAN PAB		INSTALLATION DRAWING, ALTITUDE ENCODER 429 HS TO GRAY CODE		
APPROVED EDJ				
FILE NAME 88000201-J.DWG DIRECTORY 8800-02-01				
SHEET 1 OF 2	CODE IDENT. NO. 4088-084	SIZE A	P/N 8800-02-01	REV -

00022

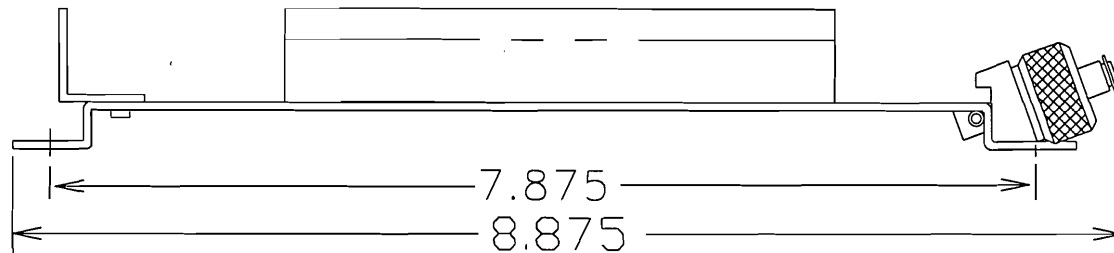
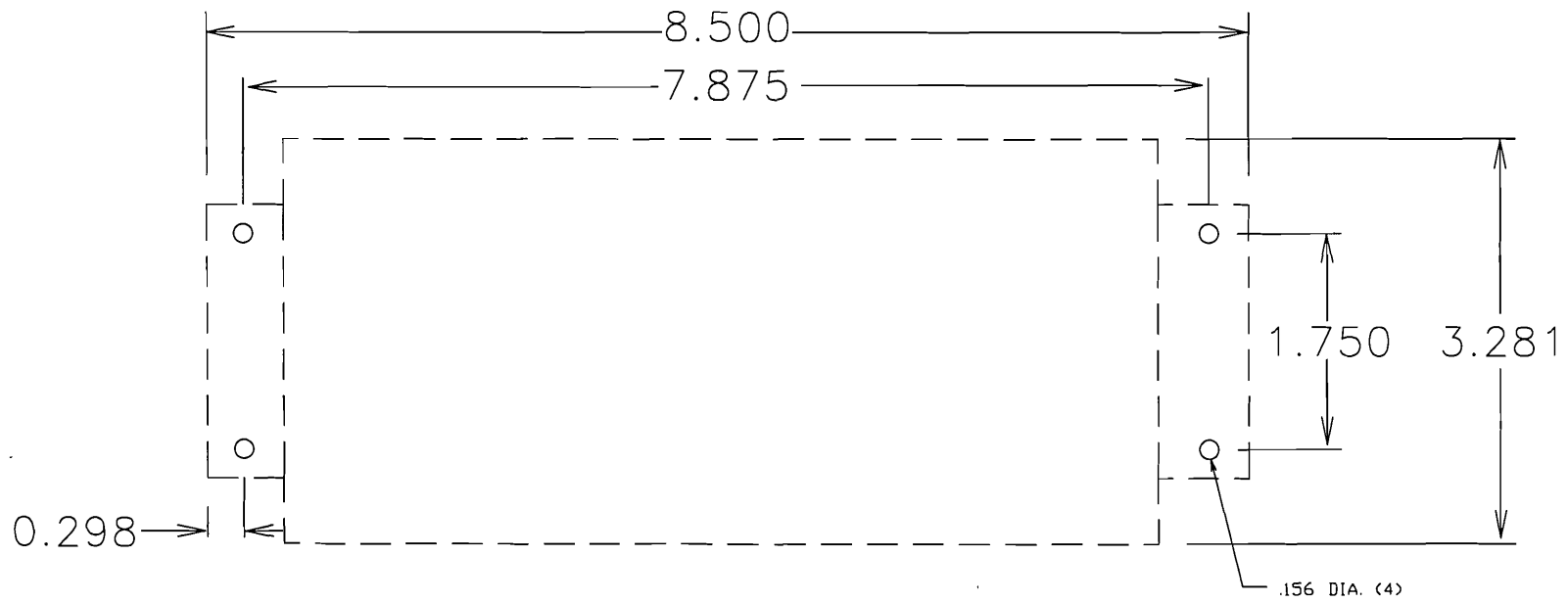

9906/012	-	6-18-99
ECC #	REV.	DATE

ORIGINAL DATE OF DRAWING 6/18/99		<b>SHADIN CO., INC.</b> MINNEAPOLIS, MINNESOTA 55447, U.S.A.		
DRAFTSMAN PAB				
CHECKED EDJ		INSTALLATION DRAWING, ALTITUDE ENCODER 429 HS TO GRAY CODE		
NEXT ASSEMBLY:				
FILE NAME 88000201-J.DWG	CODE IDENT. NO. 4088-085	SIZE A	P/N 8800-02-01	REV -
DIRECTORY 8800-02-01	SCALE NONE	WGT.	SHEET 2 OF 2	

00023

**PARTS LIST**

Part #: **IK8802-01**

Drawing #s: NA

Description: **INSTALLATION KIT, P/N 8800-02-01**

<u>FN</u>	<u>P/N</u>	<u>QTY.</u>	<u>DESCRIPTION</u>	<u>MFG.</u>	<u>MFG.#</u>	<u>DESIGNATION</u>	<u>COMMENTS</u>
5	230082	1	CONN HOOD, 37 Pin D-Sub ST	CIN	DC-24660		
10	232002	1	CONN SHELL, 37 Pin D-Sub, Fem Crimp	AMP	205167-1		
15	230055	37	CONTACT, Crimp D-Sub, Fem, 20-24, M39029/63-368	POS	M39029/63-368 (FC6020D)		
20	511002	2	SCREW, 4-40 x 1/4" Phil Pan HD SS	MCM	91772A106		
25	541001	2	WASHER, #4 Split Lock SS	MCM	92147A005		
30	613253-6	1	MOUNTING TRAY ASSEMBLY	SHA	4036-039		
35	753217	1	COMPUTER LABEL, 3.5"x 15/16"	AVR	4013		
40	PK1002	1	BAG, 3 x 4, 4 MIL Zip Lock				
45	PK1009	1	BAG, 6 x 12, 4 MIL				

47 items